

GODREJ SUMMIT

SECTOR 104, GURGAON

JOINT VENTURE PARTNERS

ZARA | SANYA



PRESENTING **READY-TO-HOST** PREMIUM RESIDENCES



Artist's impression

MASTER LAYOUT PLAN



LEGEND

1. COMMUNITY CENTRE
2. SWIMMING POOL
3. KIDS POOL

4. TENNIS COURT
5. BADMINTON COURT
6. MULTIPURPOSE COURT

7. PRIMARY SCHOOL
8. NURSERY SCHOOL -1
9. NURSERY SCHOOL -2

10. CONVENIENCE SHOPPING
11. YOGA AND MEDITATION AREA
12. KIDS PLAY AREA

13. COURTYARD
14. SENIOR CITIZEN ARENA
15. SKATING RINK

16. AMPHITHEATER
17. HALF BASKETBALL COURT
18. EWS

LOCATION MAP

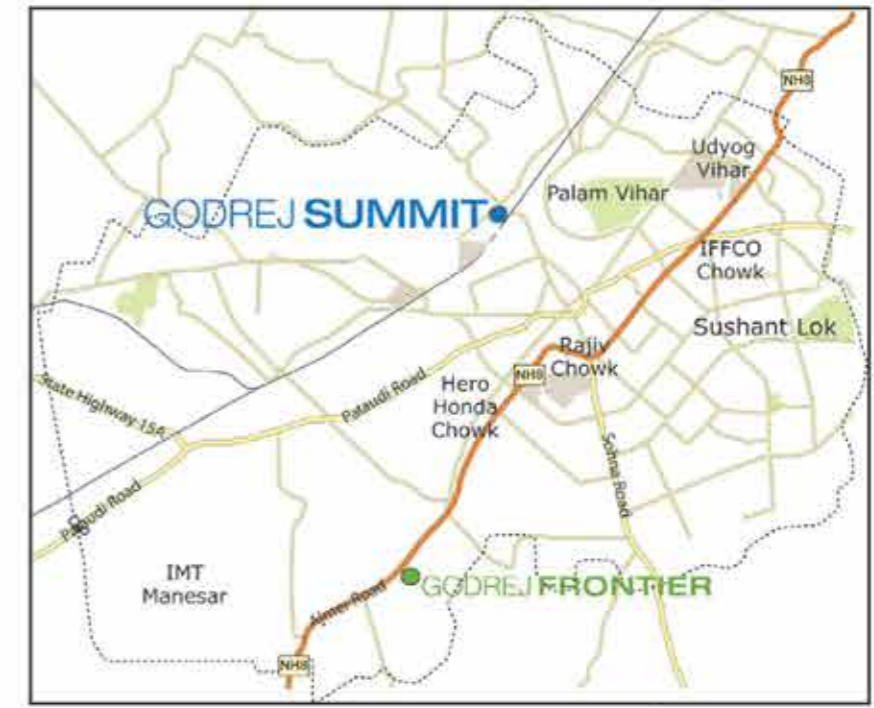
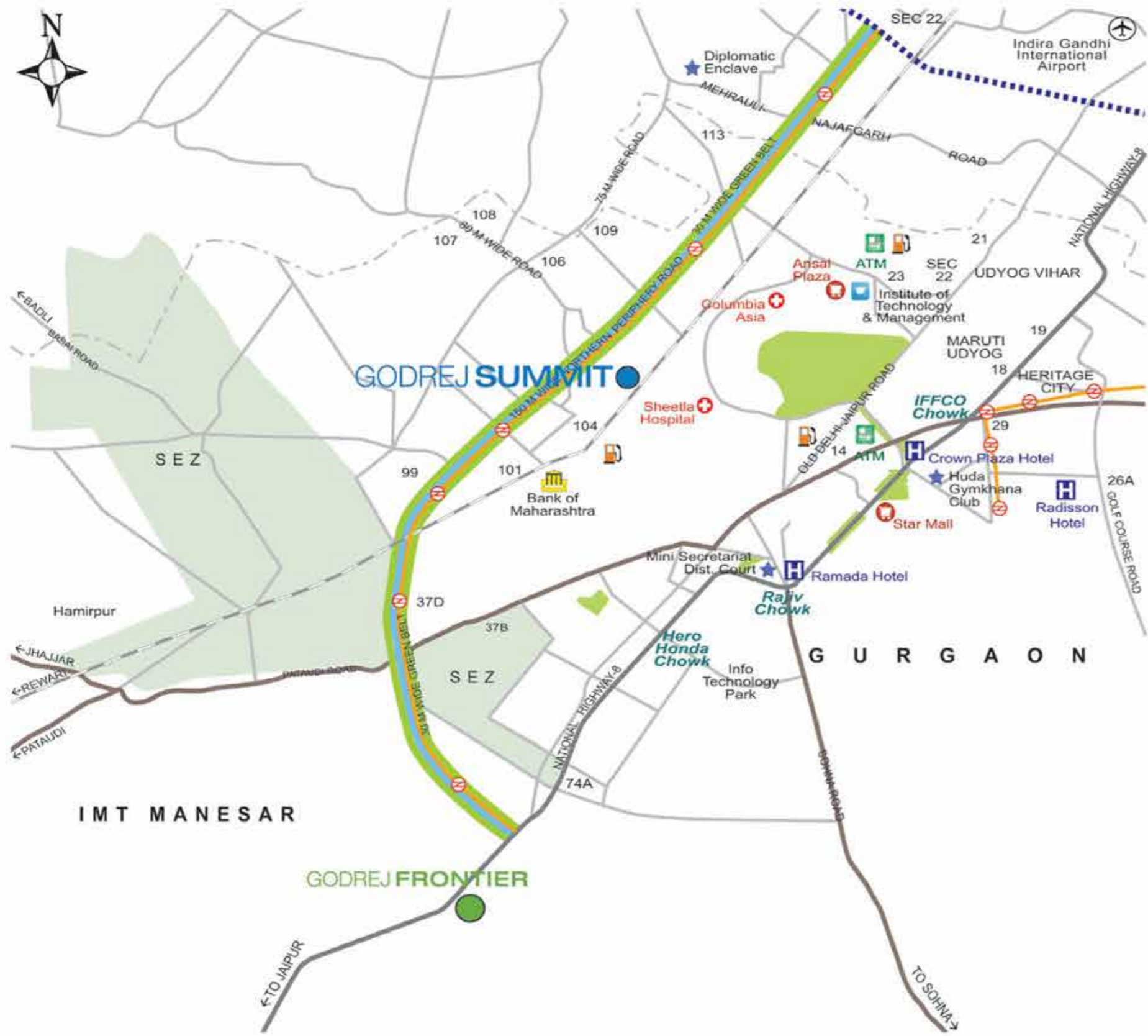

PRESENTING
READY-TO-HOST
CLUBHOUSE - THE PEAK

REJUVENATE AT THE STATE-OF-THE-ART CLUBHOUSE

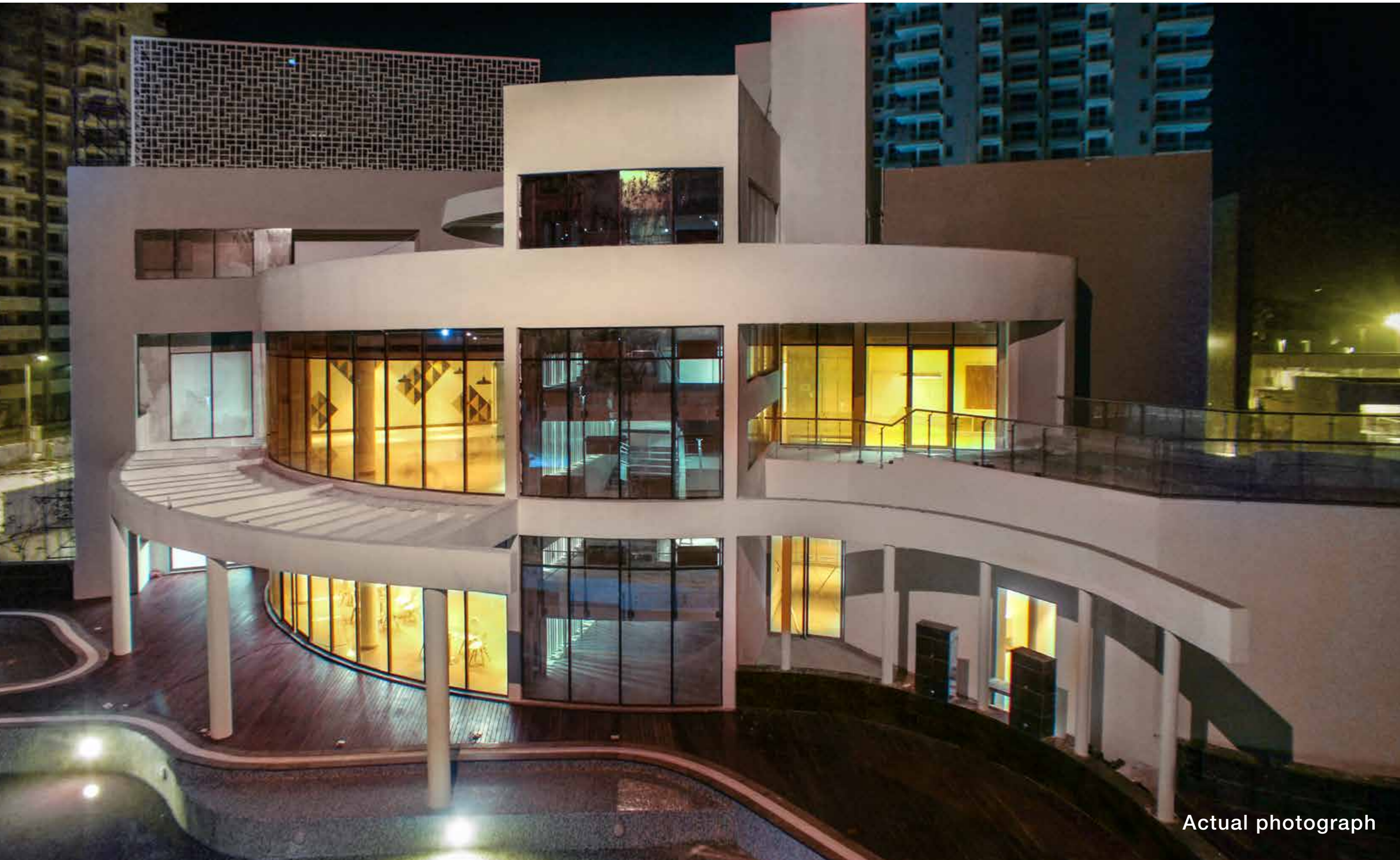

Actual photograph

ENJOY YOUR MOVIE WEEKENDS IN THE **PRIVATE MINIPLEX**



PRIVATE MINIPLEX EQUIPPED WITH **PROCELLA AUDIO**



The World's Finest Home Cinema Loudspeakers

"Procella speakers are the best cinema speakers we have heard"

-BILD & LJUD HEMMA/LYD & BILDE magazine

Artist's impression

GET FITTER AT A BRANDED GYM BY **PRECOR EQUIPMENTS**



GET SERVED IN STYLE AT THE **POOLSIDE CAFE**



CELEBRATE THE PRECIOUS OCCASIONS - **MULTIPURPOSE HALL**



LET YOUR CHILDREN UNWIND AT THE **KIDS PLAY AREA**



DISCOVER THE GAMES YOU LOVE - **INDOOR GAMES ZONE**



STAY PAMPERED AT A **BRANDED SALON**



PRESENTING
READY-TO-HOST
COMFORT & CONVENIENCES

RELISH **COMFORT & CONVENIENCES** AT YOUR DOORSTEP



Artist's impression



Artist's impression



Artist's impression



Artist's impression



Artist's impression

PROJECT MANAGED BY GLOBAL LEADING
FACILITIES MANAGEMENT COMPANY



FULFILL YOUR GROCERY NEEDS WITH **DAILY NEEDS STORE**



Artist's impression

LIFE SIMPLIFIED WITH **CONCIERGE SERVICES BY EYL**



Artist's impression

COMMUTE SMARTER WITH **SHUTTLE SERVICES BY ZIPGO**



Artist's impression

PRESENTING
READY-TO-HOST
ACTIVE LIFESTYLE

STAY ENERGIZED WITH A HOST OF **ACTIVITIES**



PRESENTING
READY-TO-HOST
SECURED LIVING

YOUR SAFETY IS OUR PRIORITY



PRODUCT CONFIGURATION

CONFIGURATION	STARTING TICKET SIZE (In Crores)
2 BHK	₹ 0.72
2.5 BHK	₹ 0.82
3.5 BHK	₹ 1.03 / ₹ 1.07*
4.5 BHK	₹ 1.32 / ₹ 1.37*
4.5 BHK + STUDY	₹ 1.53 / ₹ 1.58*

Note: Community Center membership charges – ₹ 2.5 lacs, Govt, Charges (EDC/IDC, Service Tax, cess, HVAT, Stamp Duty, etc.) will be charged as per actuals in addition to the above mentioned charges

*Towers A & L with additional specifications - Imported marble in living / dinning area, CCTV camera in living room with live feed on mobile phone, card access in the tower & basement lobby, Video door phone and CCTV camera on all floors

FULLY AIR CONDITIONED APARTMENTS



Artist's impression

WARDROBE IN MASTER BEDROOM



Artist's impression

MODULAR KITCHEN WITH CHIMNEY AND HOB



Artist's impression

15:75:10 PAYMENT PLAN

MILESTONE	PAYMENT DETAILS
BOOKING AMOUNT	₹ 3 LACS
2 MONTHS	10% - BOOKING AMOUNT
3 MONTHS	5%
ON APPLICATION OF OC/ 1ST FEB 2018*	75%
ON OFFER OF POSSESSION	10% + CCMF + EDC/IDC

*Whichever is later

Note: CCMF - Community Centre Membership Charges

PROPERTY MAINTENANCE



1 year maintenance free from offer of possession

2 YEARS CONCIERGE SERVICES FREE FROM OFFER OF POSSESSION



Artist's impression

EXCLUSIVE PREMIERE OFFERS ONLY VALID ON 10TH & 11TH JUNE



Furnished* Residences

- Air conditioners in all rooms
- Modular Kitchen with Hob & Chimney
- Wardrobe in Master Bedroom



Concierge Services

- Free for 2 years

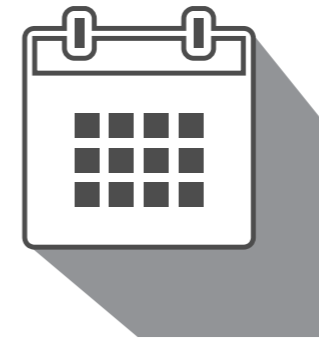

Flexible Payment Plan

15:75:10



Maintenance Charges

- Free for 1 year



JOINT VENTURE PARTNERS

ZARA | SANYA



The images are artist's impressions indicating the anticipated appearance. The furniture, accessories, paintings, items, electronic goods, additional fittings/fixtures, decorative items, false ceiling including finishing materials, specifications, shades, sizes and colour of the tiles etc. shown in the image are only indicative in nature and are only for the purpose of illustrating/indicating a possible layout and do not form part of the standard specifications/amenities/services to be provided in the flat. All specifications of the flat shall be as per the final agreement between the Parties.